

Brewista®  
ratio : scale  
BWRRS1

quick start guide



Scan for Video



start here.

## • What's in the box?

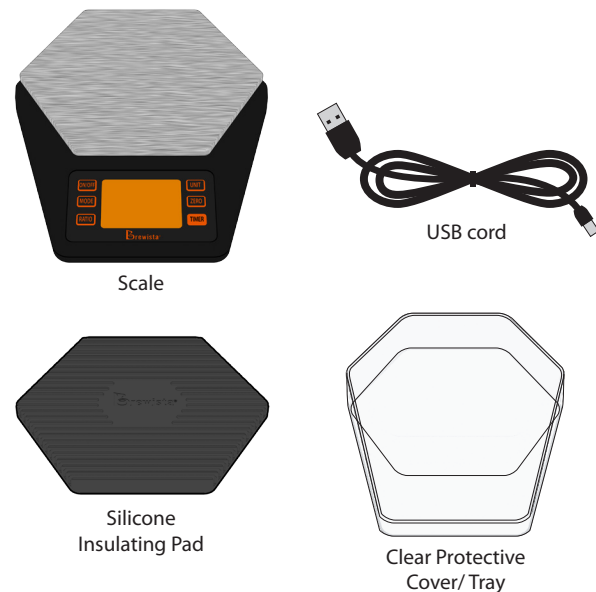

## • Components

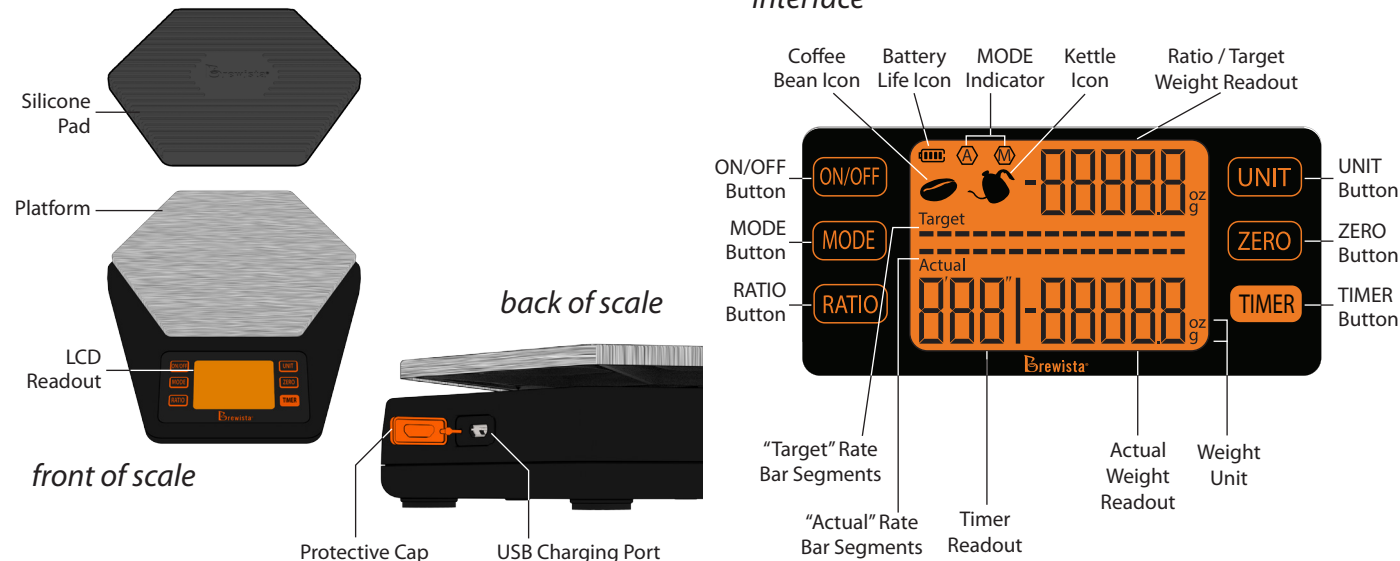

## • Charging the Battery



- Open the orange USB port cover at the back of the scale.
- Insert a micro USB cable (not included) into the port.
- Insert the large end of the USB cable into a USB compatible outlet to charge your scale's battery.
- The scale will automatically turn on to verify that the charging cord is correctly connected. We recommend turning off the scale manually at this time to reduce charging time.
- When charging is finished remove USB cable from scale and replace the port cover.

## • Turning Scale On

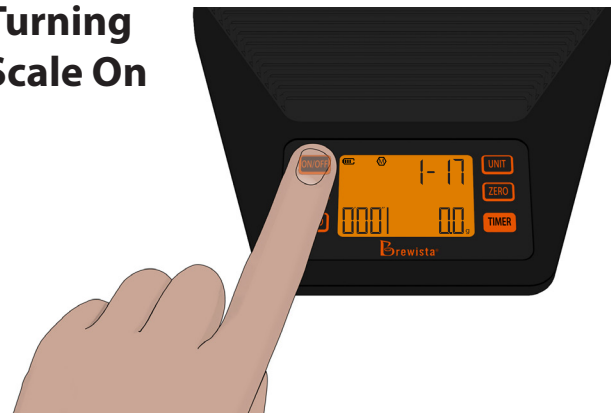

- Press the ON/OFF button once to power on the scale.
  - Wait for scale to zero before adding weight to the platform.
  - Scale returns to last mode used when turned on.
- The brewing ratio will display in the upper right for 3 seconds then go blank.
  - The last ratio that was used will be displayed.

## • Mode Setting

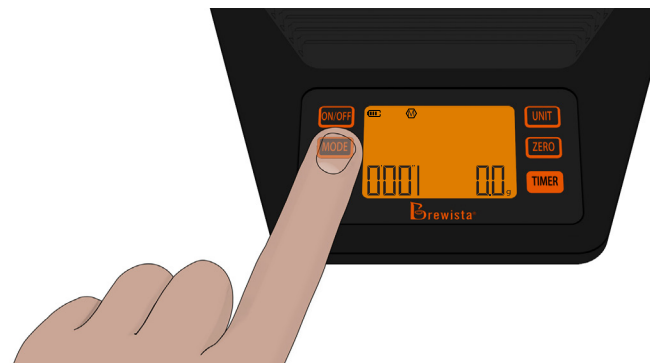

- Press "ON/OFF" button to turn on your scale. Wait until the LCD displays zero.
- The display will read "A" (automatic) or "M" (manual) in the upper left of the LCD readout.
- Press MODE button to toggle between these two modes.

## • Auto-off Function

set to 180 seconds by default

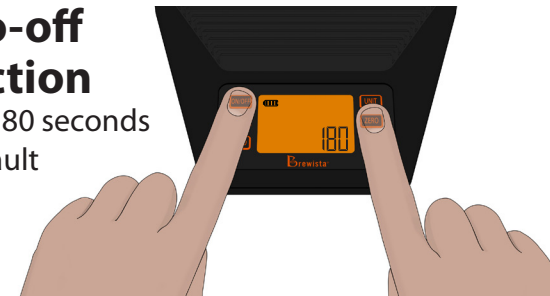

- Turn off the scale.
- Press and hold the ON/OFF button.
- While holding the ON/OFF button, press the ZERO button 4-5 times quickly until "180" is shown on the LCD display.
- Release both buttons.
- Press the ZERO button to switch between "0/60/120/180".
- If "0" is selected, the Auto-off function will be disabled.
- After choosing the desired time, press the ON/OFF button again.
- The display will show "PASS" to confirm this setting.
- The scale will turn off automatically.
- **Note:** To keep a longer battery life, please turn off the scale by pressing ON/OFF button after each use.

## • Manual Mode

(No Automatic Functions)

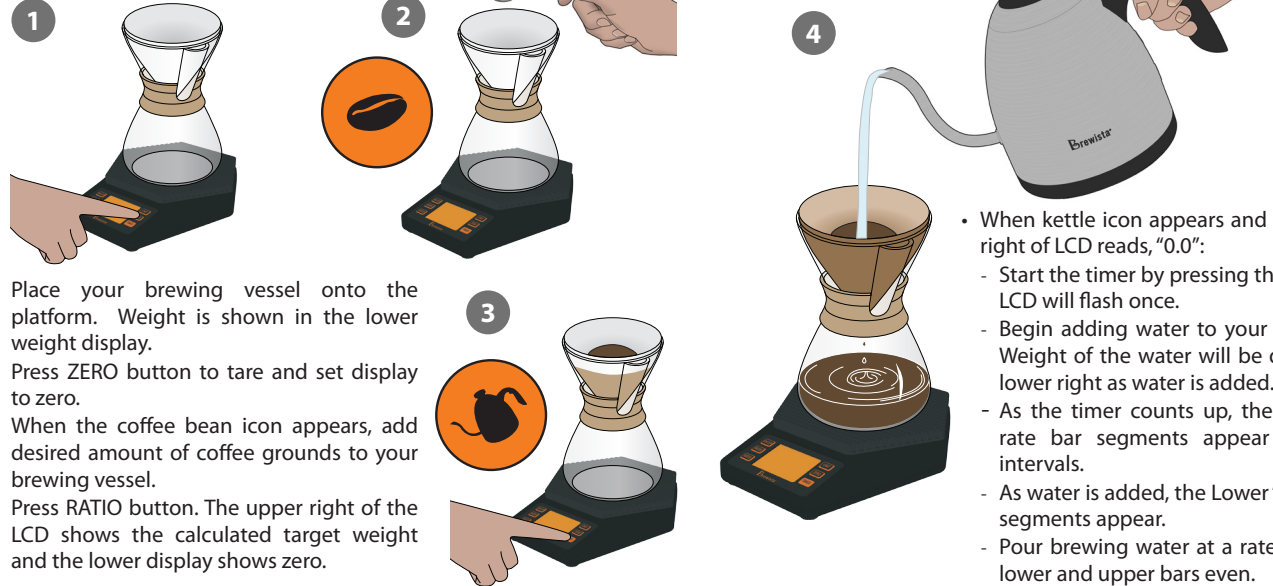

- Place your brewing vessel onto the platform. Weight is shown in the lower weight display.
- Press ZERO button to tare and set display to zero.
- When the coffee bean icon appears, add desired amount of coffee grounds to your brewing vessel.
- Press RATIO button. The upper right of the LCD shows the calculated target weight and the lower display shows zero.

- When kettle icon appears and weight in lower right of LCD reads, "0.0":
  - Start the timer by pressing the TIMER button. LCD will flash once.
  - Begin adding water to your brewing vessel. Weight of the water will be displayed in the lower right as water is added.
  - As the timer counts up, the Upper "Target" rate bar segments appear at 10 second intervals.
  - As water is added, the Lower "Actual" rate bar segments appear.
  - Pour brewing water at a rate that keeps the lower and upper bars even.

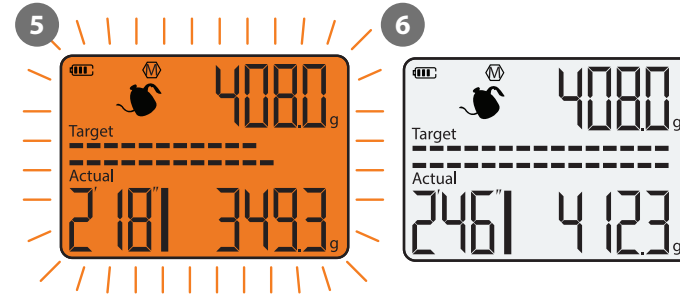

- When the weight of the water added reaches 60g less than the calculated amount shown at the top right, the screen begins to flash. This means that you are close to the final amount of water needed.
- Once the lower display reading reaches the upper display volume the entire display screen will change color from orange to white.
- Stop adding water to the brewing vessel.
  - If the vessel is removed from the scale weight in lower right will show a negative reading.
  - Timer will continue. Press the TIMER button to stop the timer.
  - Press the TIMER button again to reset the timer to zero.
  - Press the ZERO button to clear the weight reading and the ratio.
  - Your scale is now ready for another brew.

## • Changing the Set Ratio

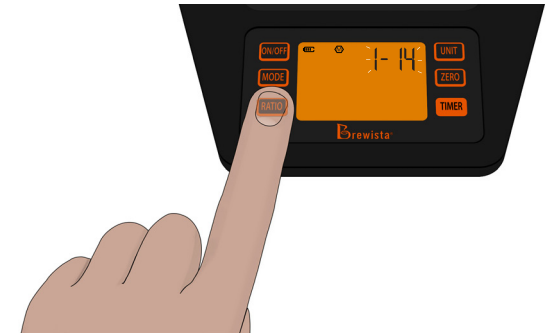

- Press and hold the RATIO button for 3 seconds. The ratio will display blinking in the upper right of the LCD.
- Press the RATIO button until the desired ratio is displayed.
  - The default ratio is 1:17 (add 1 part coffee to 17 parts water).
  - Scale has 7 pre-set ratios: 1:14, 1:15, 1:16, 1:17, 1:18, 1:19, and 1:20
- Wait three seconds and the scale will automatically store the new ratio and return to the mode you were in last.

**Note:** Ratio cannot be changed once the brewing process has begun.

## • Auto Mode

(Automatic Zero and Timer)

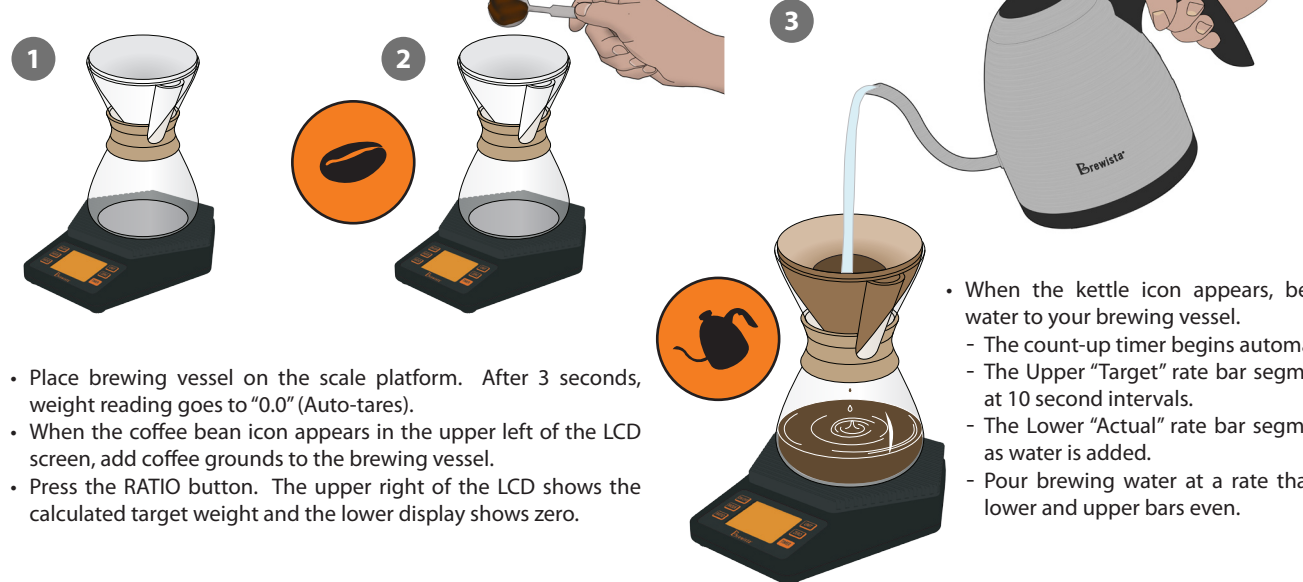

- Place brewing vessel on the scale platform. After 3 seconds, weight reading goes to "0.0" (Auto-tares).
- When the coffee bean icon appears in the upper left of the LCD screen, add coffee grounds to the brewing vessel.
- Press the RATIO button. The upper right of the LCD shows the calculated target weight and the lower display shows zero.

- When the kettle icon appears, begin adding water to your brewing vessel.
  - The count-up timer begins automatically.
  - The Upper "Target" rate bar segments appear at 10 second intervals.
  - The Lower "Actual" rate bar segments appear as water is added.
  - Pour brewing water at a rate that keeps the lower and upper bars even.

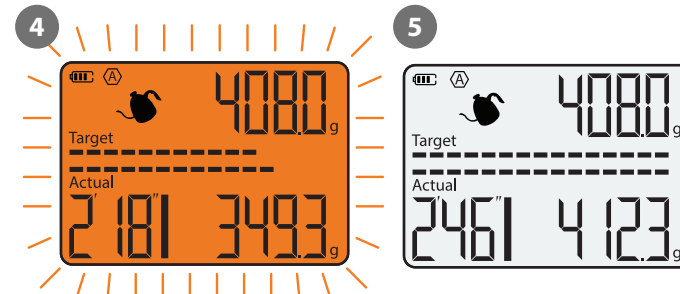

- When the weight of the added water reaches 60g less than the calculated amount shown at the top right of the LCD, the screen begins to flash. This means that you are close to the final amount of water needed.
- Once the Target Weight is reached, the display color will change from orange to white.
  - Timer continues to count up.
  - Weight reading will show actual weight even if it is over the target amount.
- Remove brewing vessel after brewing is complete.
  - Weight and final Time reading remains on the display for five seconds then return to zero.
  - Scale is now ready for another brew.

## • Washing Instructions

- Wipe scale clean with soft, damp cloth.
- Do not submerge the scale in water. Doing so may require excessive drying time and damage the scale.
- Do not press hard on the platform.
- Dry the exterior of the scale with a soft cloth or leave to dry on a dish rack with the LCD and buttons pointing upward.



**Brewista® ratio : scale**  
BWRRS1

1133 W. 27th Street, Cheyenne, WY 82001, USA | [www.mybrewista.com](http://www.mybrewista.com)  
Toll Free in North America: 888-538-8683 | Local: 307-222-6086